



Well House Manor  
 48 Spa Road  
 Melksham  
 Wiltshire  
 SN12 7NY

+44 (0) 1225 709 638  
[www.wellhousemanor.co.uk](http://www.wellhousemanor.co.uk)  
[events@wellhousemanor.co.uk](mailto:events@wellhousemanor.co.uk)

**Events Packages** (pricing is for up to 10 delegates, except where noted)

all prices include VAT

	hotel room and breakfast (for up to 10)	use of "The Wilts" (seats up to 35)	use of "The Berks" (seats up to 10)	buffet lunch in dining room (hot and/or cold)	dinner in dining room (table or buffet)
<b>Platinum</b> £700	●	●	●	●	○
<b>Gold</b> £600	●	●	●	○	○
<b>Silver</b> £400	●	○	○	○	○
<b>Bronze</b> £250	○	●	●	○	○

● included in price  
 ○ optional, available at an extra price

By choosing a Platinum or Gold package, you have full use of the hotel facilities with no other guests booked in during your stay. If you choose the Silver package, you have full use of all the hotel rooms, but day conferences may be booked separately. With the day conference Bronze package, you will have full use of the two conference rooms only; overnight hotel guests will be using the Whitworth dining room for breakfast.)

**Rooms**

There are five hotel rooms (all en suite). One room is purpose-built as a twin, another 2 rooms are convertible to twin; the remaining two rooms are doubles. With this in mind, we can accept up to 10 people; two people sharing each room. Arrival is the night before your conference. Check in is 3pm; checkout is 11am. **Additional option price:** Conference delegate rate: £60 per room per night; one or two people sharing one room with continental breakfast included. (Normally £80-95 per room.)  
 Reserve all five rooms: £400 per night.

**Beds**

Three rooms have two single beds each. In one room they are placed separately. In another room they are either placed separately, or together to make one super king-sized bed. Each single bed measures 3'0" x 6'6" (900mm x 2000mm). One room has a king-size bed measuring 5'6" (1680mm x 2000mm). One room has a super king-size bed measuring 6'0" x 6'6" (1900mm x 2000mm)

**Breakfast**

Continental breakfast is served, normally between 7am and 9am; however, with the Platinum, Gold and Silver packages above, you may time breakfast according to your group's needs. We take pride in serving a good selection of locally produced food. A flexibility of choice, and catering to special diets is entirely possible with advance planning. **Additional option price:** £20 per person per day.

**Breaks**

Room hire also includes two refreshment breaks each day, one in the morning to feature fruit and beverage choices\*, and one in the afternoon to feature pastry and beverage choices. **Additional option price:** £20 per person per day.

\* beverage choices: freshly brewed coffee - regular and decaf, tea including herbals, water, fruit juice and soft drinks

**Lunch**

A buffet lunch to be arranged in advanced based on preset menu choices; alterations possible at additional cost. **Additional option price:** £30 per person per day; includes morning and afternoon breaks.

**Dinner**

A buffet or table service can be arranged on request. **Additional option price:** varies.

## The Wilts

5000mm x 9520mm (47.6sqm)

A conference room that comfortably seats 11 people at tables arranged in a U shape (shown left).

The room contains 11 UK 230volt double sockets and is enabled for wired and wireless 10Mbit broadband Internet, and hubs to also create an intranet circuit.

Overhead lighting is controllable to provide full room lighting, dedicated area lighting and subdued lighting at the front if projecting. The front side wall surfaces are covered with WriteOn® and the front wall is covered with Write/ProjectOn®. Whiteboard pens and erasers provided for use. Delegates are given pads and pens that they are able to take away. Multiways and hubs are provided as needed. Also available at an extra cost are use of:

- Laptop computers (a choice of: Microsoft Windows XP, Linux, Macintosh operating systems)
- Projector

Other configurations possible:

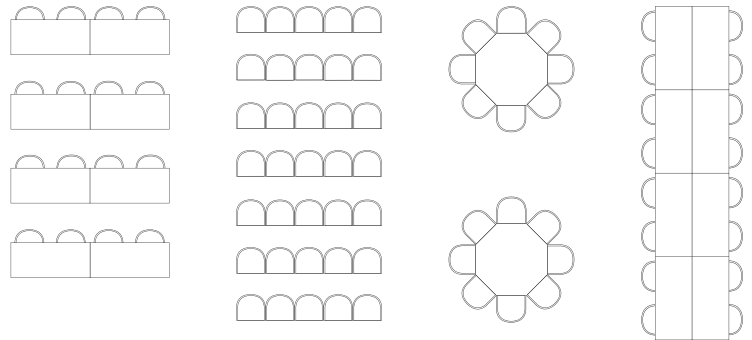

**Available on separate hire for £100 per day plus £20 per person per day for two refreshment services.**

## The Berks

4250mm x 4900mm (20.825sqm)

This room can easily be used as your break-out room if hired with The Wilts, or as a separate conference room.

The room contains 3 UK 230volt double sockets and is enabled for wired and wireless 10Mbit broadband Internet, and hubs to also create an intranet circuit. Also sited in the room is a large utility basin.

One wall surface is covered with Write/ProjectOn®. Whiteboard pens and erasers provided for use. Delegates are given pads and pens that they are able to take away. Multiways and hubs are provided as needed. Also available at an extra cost are use of:

- Laptop computers (a choice of: Microsoft Windows XP, Linux, Macintosh operating systems)
- Projector

**Available on separate hire for £50 per day plus £20 per person per day for two refreshment services.**

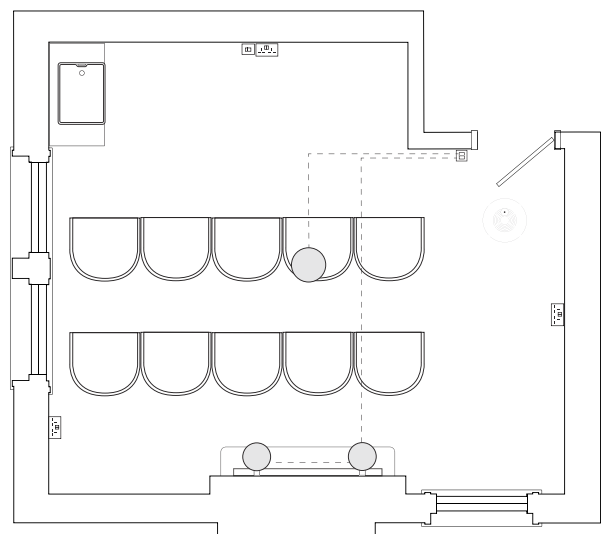

*Well House Manor is a non-smoking, non-licensed facility. You may bring alcohol, which we will uncork and provide glasses for, but we do not sell alcoholic beverages.*

*overleaf*